

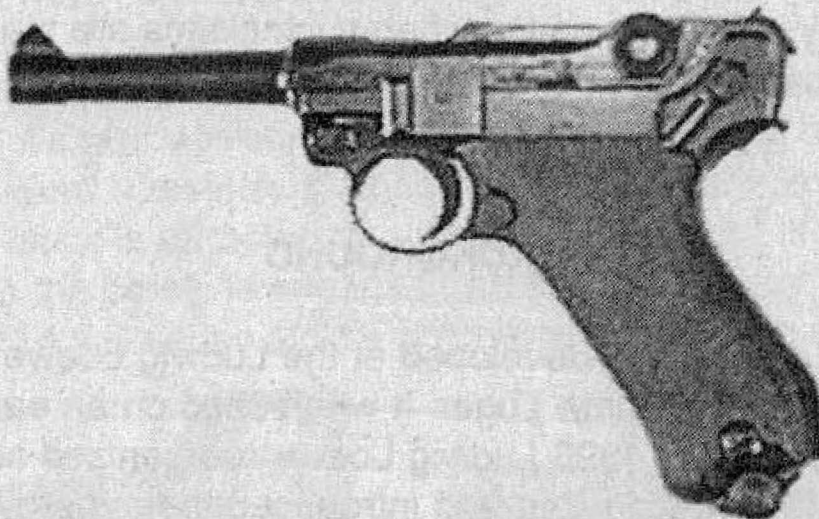

**CENTURY
INTERNATIONAL
ARMS, INC.**

800 527-1252

**GUIDE ON THE USE OF THE GERMAN
MODEL P.08 PISTOL
CALIBER 9mm PARABELLUM (9x19mm)**



INTRODUCTION

As a responsible firearms owner, carefully read this manual and be sure you understand all the instructions before using this firearm. Mishandling or carelessness in it's use may result in the accidental discharge of the firearm which could result in property damage, injury, or death. If you are not familiar with firearms or their use, seek advice through safe handling courses run by your local gun and sporting club, NRA approved instructor or similar qualified organizations. This manual should accompany the firearm and be transferred upon change of ownership.

Thoroughly examine the pistol after reading the manual to insure it is in good condition. All returns are subject to a restocking fee and must have an authorization number. Call our Customer Service Department at 1-800-527-1252 for further details. All requests should be submitted promptly. No items will be accepted for return after 30 days.

NOTICE

Claims will not be honored for damage, injury or, death resulting from the intentional or accidental discharge of this firearm, or from it's function when used for purposes or subjected to treatment for which it was not designed. Claims will not be honored which result from careless or improper handling, unauthorized adjustments or parts replacement, corrosion, neglect, or the use of improper, handloaded or remanufactured ammunition. No claims will be honored involving this firearm for any reason or cause when such claims are made by the second or subsequent owner.

BACKGROUND

The 08 pistol design was developed at the Ludwig Loewe factory in Berlin, Germany by George Luger. It was based on an earlier design by Hugo Borchardt. In 1896 Ludwig Loewe reorganized as Deutsche Waffen und Munitionsfabriken and introduced their improved model in 1900. In 1908, a refined model was adopted for service by the Imperial German Army as the "Pistole 08". During the First World War, the 1908 was made at the government arsenal at Erfurt as well as by DWM. Nearly two million pistols were made during the war.

The German defeat in 1918 halted government production of this pistol. DWM continued to manufacture the pistol under the terms of the Treaty of Versailles. In 1930, all P.08 production was transferred to the Mauser Werke factory at Oberndorf, Germany. During Germany's period of rearmament, 1908 pistols were stamped with a code which was intended to conceal production figures. In 1938, rising production costs forced the replacement of the 1908 pistol by the simpler and more modern Walther P-38. Although the P.08 remained in service throughout the war, all production ceased in 1942.

FEATURES

The P.08 is a semi-automatic, recoil operated, pistol with a toggle-joint locked breech and internal striker firing system. It's design allows it to fit comfortably in the hand. It is fed by a eight-shot, single column, detachable box magazine inserted into the grip. The extractor, which is located on the top of the bolt, acts as a loaded chamber indicator. When the chamber is loaded, the extractor projects up above the bolt exposing the word "**Geladen**" (loaded).

The safety is a thumb operated lever located on the left rear side of the frame. In it's rear position, it blocks the operation of the sear and exposes the word "**Gesichert**" (made safe). When the lever is pushed forward, the block is retracted and the word Gesichert is covered.

NOTE: When the safety is engaged, the sear is blocked. DO NOT pull the trigger. This will cause stress which could break the mechanism.



DATA

Weight..... 1 lb. 14 oz.
Length..... 8 3/4"
Barrel Length..... 4"
Rifling..... 6 grooves, right twist.
Sights..... Front : Inverted V. Rear : Fixed V notch.
Caliber..... 9mm Parabellum.

SAFETY FIRST !

When purchasing a firearm, you assume responsibility for its safe use, storage and transportation.

- * Always treat a firearm as if it were loaded.
- * Always know where the muzzle is pointed.
- * Check the barrel before shooting to be sure it is free of obstructions.
- * Do not leave firearms or ammunition unattended. Secure it against access by unauthorized users.
- * Before you shoot, be sure that the area beyond your target (including the backstop) is clear and safe. Make sure that shots fired do not present a safety hazard to yourself or others.
- * Always use proper ear and eye protection when shooting.
- * Always use factory loaded ammunition of the type and caliber designed for your firearm.
- * Do not allow the firearm to be used by anyone not trained in its proper operation.
- * Never pass the firearm to anyone unless the action is open and the firearm is unloaded and in a safe condition.
- * When not in use store the firearm unloaded in an area secure from unauthorized access. Store any ammunition in a separate secure area.

OPERATION

Keep all ammunition away from the pistol until you are familiar with the manual and the operation of the pistol. Examine the pistol before use to confirm it is clean and complete, checking for any visible damage or missing parts. If anything is missing or out of place, DO NOT load or fire the pistol, call for advice from a qualified authority first.

LOADING

Open the bolt by pulling back the toggle action until it is locked in place by the magazine follower (if it won't, something is wrong). It may require some effort, the recoil spring is strong. Put the safety lever in the SAFE position. Remove and examine the magazine and action to confirm that the pistol is not loaded, the action will remain open. Check the bore to see it is dry and clear of any obstruction (including excessive grease or oil).

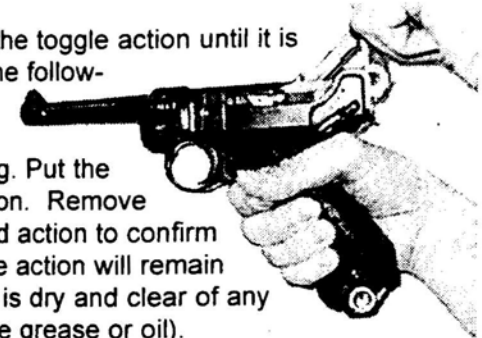

To load the magazine, pull down the follower button on the side to lower the follower while loading a cartridge from the front of the magazine (they are held by the lips on the top of the magazine). **Do not** load ammunition directly through the top of the magazine. Repeat until the magazine is full. Load the magazine into the pistol by inserting it into the grip frame and pushing upward until you feel the magazine catch snap into place.

SHOOTING

First, confirm the area behind the target is clear. Keeping the pistol pointed "down-range", and your finger out of the trigger guard, hold the pistol in your shooting hand while grasping the open toggle with your other hand. Pull back the toggle as far as you can (it should move about 1/8") and release.

Don't lower gently, allow it to go forward under recoil spring pressure. The toggle will cause the bolt to strip the first round from the magazine and feed it into the chamber. The pistol is now loaded with the safety in the on position. Note the loaded chamber indicator. Push the safety lever fully forward.

THE PISTOL IS NOW READY TO FIRE.

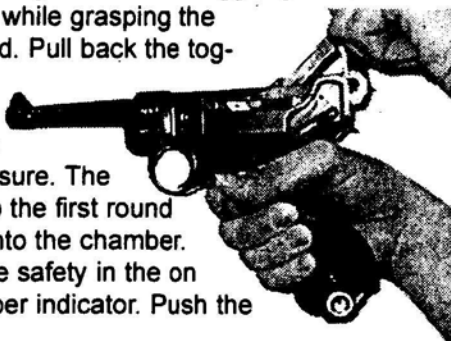

This pistol has what is referred to as a "two-stage" trigger which means that you will have to take up the initial slack until you feel the trigger tighten. The trigger should break cleanly at the second stage, firing the pistol. The toggle joint remains locked until recoil forces the barrel extension and bolt against an inclined surface in the frame which causes the toggle to buckle upward in a hinge like action. This opens the bolt, ejecting the spent case and cycling the action to load the next round and cock the firing pin. This is repeated each time you pull the trigger until the magazine is empty.

When the magazine is empty, the follower button will engage the hold open device. This will lock the action in the open position. The magazine can be withdrawn for re-loading. The toggle will remain open until manually released.

UNLOADING

If you change your mind and do not wish to shoot, please be aware that the pistol is now ready to fire.

DO THE FOLLOWING:

- 1.) Put the safety lever in the **SAFE** position.
- 2.) Remove and unload the magazine.
- 3.) Grasp the toggle of the gun and draw them rearward smartly to eject the round from the chamber.
- 4.) Replace the **empty** magazine into the pistol.
- 5.) Retract the toggle again to the rearward position and they will stay open. Examine the action to be sure the gun is empty.

When you choose to stop shooting, leave the magazine out of the pistol and lower the toggle (grasp the toggle, pull back to unlock then release). Note the chamber indicator to see it does not protrude. Replace the empty magazine. Verify the gun is empty. Swing the safety lever into the **SAFE** position. Be sure to pick up any unused ammo and used casings.

CARE AND CLEANING

Any firearm is a precision instrument and requires cleaning and care to insure its continued and safe function. After every **shooting** session, the pistol should be cleaned and oiled thoroughly. Any good quality gun cleaner will do nicely.

First be sure that the pistol is unloaded by removing the magazine and checking the loaded chamber indicator. Replace the magazine and lock the toggle in the open position. Then remove the magazine and set aside. This will expose the bore as well as the toggle links.

Using a good bore cleaner and a brass bristle brush, swab the bore. Dry with cloth patches until no residue remains. The bolt face and magazine well can be cleaned with a brush soaked in gun solvent and wiped clean. If the gun is not to be used immediately, apply a light coat of penetrating oil to the bore and action, paying specific attention to the toggle link joints and the rails on which the bolt rides. Apply a light coat of protective oil to all metal finishes. Verify the chamber is empty. Release the toggle joint to close the bolt. Engage the safety. Replace the empty magazine and store the pistol securely.

No further disassembly is required for normal cleaning.

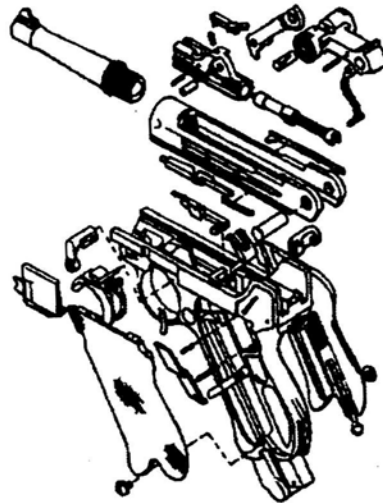

NOTES

SAFETY WARNING

Discharging firearms in poorly ventilated areas, cleaning firearms or handling ammunition may result in exposure to lead and other substances known to cause birth defects, reproductive harm and other serious physical injury. Have adequate ventilation at all times. Wash hands thoroughly after exposure.